

VERTICE 0	VERTICE 1	VERTICE 2	VERTICE 3	VERTICE 4	VERTICE 5	VERTICE 6								
XT1 = 19.981 YT1 = -89.130 SVC1 = 24.000 MCI = 62.832 YTC1 = 72.377 AC1 = 37.947 R = 60.000 SVRC = 26.608 SVL = 76.608	XV = 77.254 YV = 64.416 AV = 144.1816 AD = 55.8184 KC = 75.185 YC = -131.092 R = 15.300 SVRC = 26.608 SVL = 76.608	XT2 = 113.196 YT2 = -82.647 SVC2 = 24.000 XTC2 = 91.155 YTC2 = -73.256 AC2 = 37.947 R = 15.300 SVRC = 26.608 SVL = 76.608	XT1 = 130.626 YT1 = -31.489 SVC1 = 23.000 MCI = 130.626 YTC1 = -31.489 AC1 = 0.000 R = 15.300 SVRC = 22.798 SVL = 68.798	XV = 200.063 YV = -126.710 AV = 24.7056 AD = 175.2944 KC = 137.548 YC = -77.844 R = 50.000 SVRC = 22.798 SVL = 68.798	XT2 = 149.118 YT2 = -67.833 SVC2 = 23.000 XTC2 = 149.118 YTC2 = -67.833 AC2 = 0.000 R = 50.000 SVRC = 31.953 SVL = 31.953	XT1 = 15.568 YT1 = -2.928 SVC1 = 25.269 MCI = 15.568 YTC1 = 25.269 AC1 = 0.000 R = 11.400 SVRC = 98.439 SVL = 98.439	XV = -50.987 YV = -6.724 AV = 21.5630 AD = 178.4370 KC = 14.902 YC = 8.552 R = 160.000 SVRC = 98.439 SVL = 98.439	XT2 = 10.492 YT2 = 19.065 SVC2 = 25.269 XTC2 = 10.492 YTC2 = 19.065 AC2 = 0.000 R = 160.000 SVRC = 98.439 SVL = 98.439	XT1 = 25.269 YT1 = 25.269 SVC1 = 0.000 MCI = 25.269 YTC1 = 25.269 AC1 = 0.000 R = 160.000 SVRC = 98.439 SVL = 98.439	XV = 72.158 YV = 44.932 AV = 160.825 AD = 39.1675 KC = 87.173 YC = -122.277 R = 160.000 SVRC = 98.439 SVL = 98.439	XT2 = 121.788 YT2 = 33.934 SVC2 = 0.000 XTC2 = 121.788 YTC2 = -33.934 AC2 = 0.000 R = 160.000 SVRC = 98.439 SVL = 98.439	XT1 = 169.612 YT1 = 23.337 SVC1 = 169.612 MCI = 169.612 YTC1 = 23.337 AC1 = 0.000 R = 160.000 SVRC = 25.834 SVL = 25.834	XV = 212.888 YV = 13.747 AV = 26.8816 AD = 173.1184 KC = 171.667 YC = 32.612 R = 9.500 SVRC = 25.834 SVL = 25.834	XT2 = 177.343 YT2 = 40.230 SVC2 = 0.000 XTC2 = 177.343 YTC2 = 40.230 AC2 = 0.000 R = 9.500 SVRC = 25.834 SVL = 25.834

VERTICE 7	VERTICE 8	VERTICE 9	VERTICE 10	VERTICE 11										
XT1 = 165.226 YT1 = 49.258 SVC1 = 0.000 MCI = 165.226 YTC1 = 49.258 AC1 = 0.000 R = 120.000 SVRC = 74.641	XV = 134.295 YV = 72.303 AV = 160.4017 AD = 39.5982 KC = 236.920 YC = 145.486 R = 120.000 SVRC = 74.641	XT2 = 122.584 YT2 = 109.054 SVC2 = 0.000 XTC2 = 122.584 YTC2 = 109.054 AC2 = 0.000 R = 100.000 SVRC = 66.856	XT1 = 117.282 YT1 = 125.693 SVC1 = 0.000 MCI = 117.282 YTC1 = 125.693 AC1 = 0.000 R = 100.000 SVRC = 66.856	XV = 106.738 YV = 158.786 AV = 157.4379 AD = 42.5621 KC = 22.002 YC = 95.334 R = 100.000 SVRC = 66.856	XT2 = 178.218 YT2 = 178.218 SVC2 = 0.000 XTC2 = 178.218 YTC2 = 178.218 AC2 = 0.000 R = 200.000 SVRC = 51.358	XT1 = 34.914 YT1 = 207.673 SVC1 = 0.000 MCI = 34.914 YTC1 = 207.673 AC1 = 0.000 R = 200.000 SVRC = 51.358	XV = 207.673 YV = 227.082 AV = 183.6523 AD = 18.3478 KC = 16.7613 YC = 358.995 R = 200.000 SVRC = 51.358	XT2 = 17.283 YT2 = 227.082 SVC2 = 0.000 XTC2 = 17.283 YTC2 = 227.082 AC2 = 0.000 R = 200.000 SVRC = 51.358	XT1 = 12.722 YT1 = 232.279 SVC1 = 0.000 MCI = 12.722 YTC1 = 232.279 AC1 = 0.000 R = 160.000 SVRC = 52.311 SVL = 52.311	XV = -4.684 YV = 252.116 AV = 179.1861 AD = 20.8199 KC = -107.541 YC = 126.749 R = 160.000 SVRC = 52.311 SVL = 52.311	XT2 = -27.539 YT2 = 265.312 SVC2 = 0.000 XTC2 = -27.539 YTC2 = 265.312 AC2 = 0.000 R = 160.000 SVRC = 52.311 SVL = 52.311	XT1 = -38.967 YT1 = 271.910 SVC1 = 0.000 MCI = -38.967 YTC1 = 271.910 AC1 = 0.000 R = 95.000 SVRC = 64.847 SVL = 64.847	XV = -68.190 YV = 288.782 AV = 156.5441 AD = 43.4559 KC = 8.534 YC = 354.182 R = 95.000 SVRC = 64.847 SVL = 64.847	XT2 = -80.222 YT2 = 320.309 SVC2 = 0.000 XTC2 = -80.222 YTC2 = 320.309 AC2 = 0.000 R = 95.000 SVRC = 64.847 SVL = 64.847

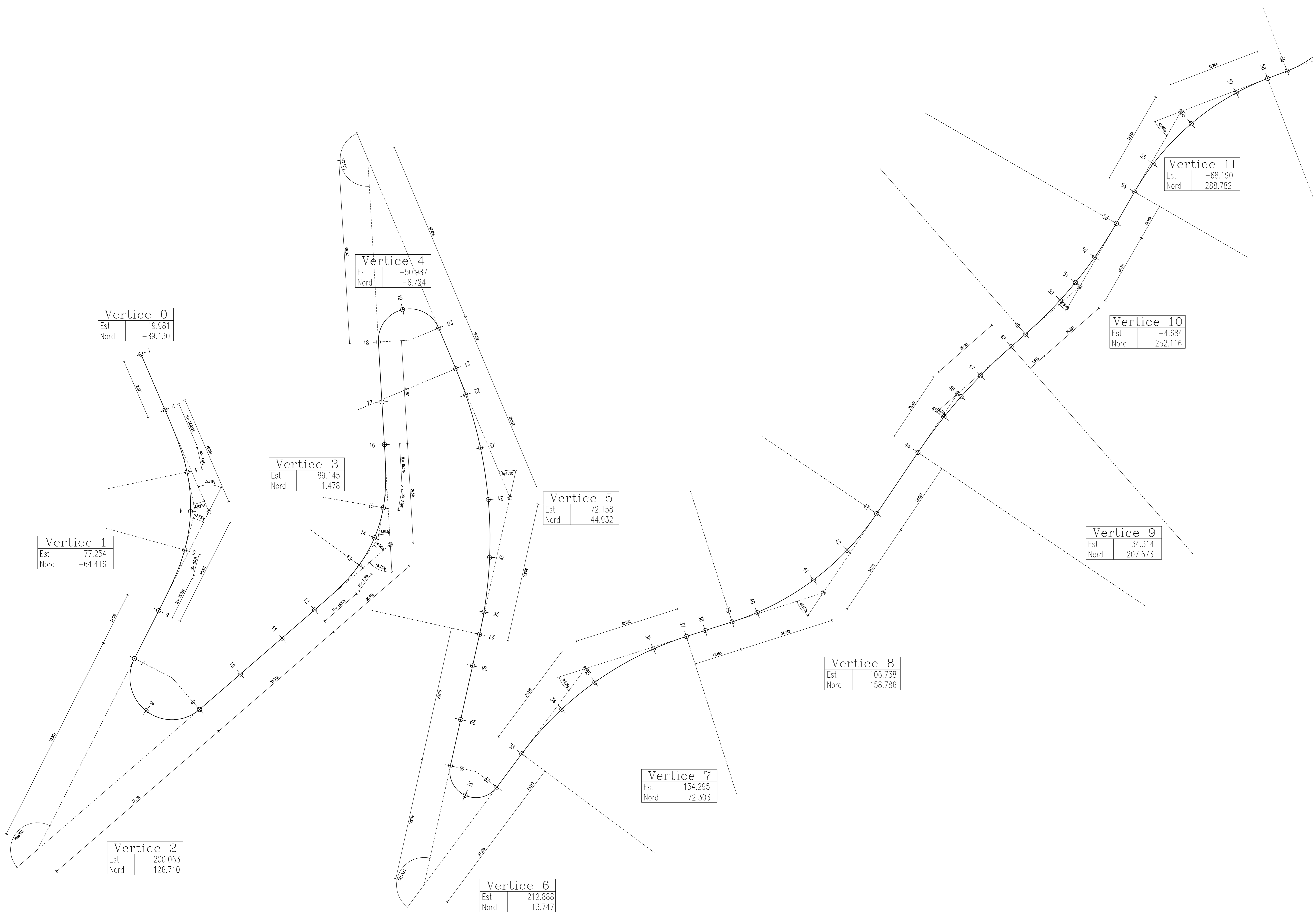

Provincia di Chieti
 Settore Lavori Pubblici

LAVORI DI SISTEMAZIONE STRADA PROVINCIALE S.S. 650
 FONDO VALLE TRIGNO SCHIAVI D'ABRUZZO

III° Lotto Funzionale

PLANIMETRIA DI TRACCIAMENTO 1 DI 4
 DA VERTICE 1 A VERTICE 11

PROGETTO ESECUTIVO

STUDIO MONTEPARA
 Ing. Antonio Montepara

TAVOLA
 7.1

Questo elaborato non può essere riprodotto né
 impiegato, né in parte per scopi diversi da
 quelli per cui è stato fornito.

Responsabile Unico del Procedimento
 DATA : 25/06/2010

127 E T I A 07.01 RO

Revisione	Data	Descrizione	Redatto	Contrattato	Approvato
REVO					
REV1					
REV2					